

F1210 Fertilizer Spreader Troubleshooting

At Beginning of Season, Run a Self-Test

- Make sure tractor isn't moving & engage all hydraulics
- Click on the "gear" icon on the home page
- Click on the second tab from the left
- Change Self Test Box to 6mph, then select the "house" icon (bottom right) when finished
- Make sure density is entered
- Make sure a rate is entered & selected on home page
- Make sure the toggle button (upper right) is on
- Make sure the foot pedal/master switch is on
- Make sure section control is off

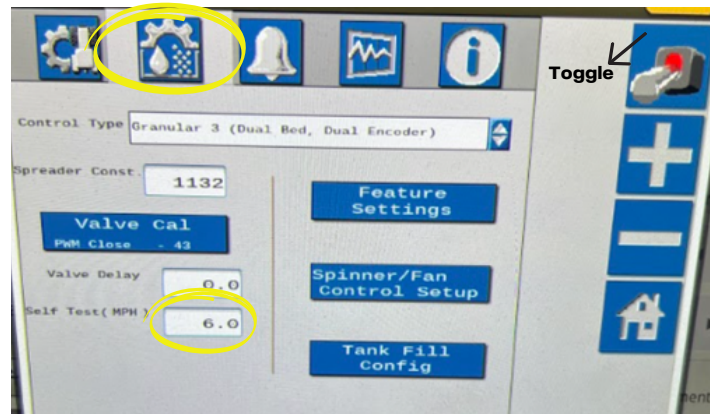

How To Calibrate Your Spreader

(4-5 times per product)

- Set density and rate (home page)
- Return to this page & click the "clear button" (under 1-2-3 button)
- To calibrate your spreader, first spread a round
- Then record the field product rate (in totals screen) & scale weight applied
- 2-10% off in rate is acceptable
- Re-enter spreader constant value (see formula below)
 - You can find spreader constant value under settings & second tab from left on top

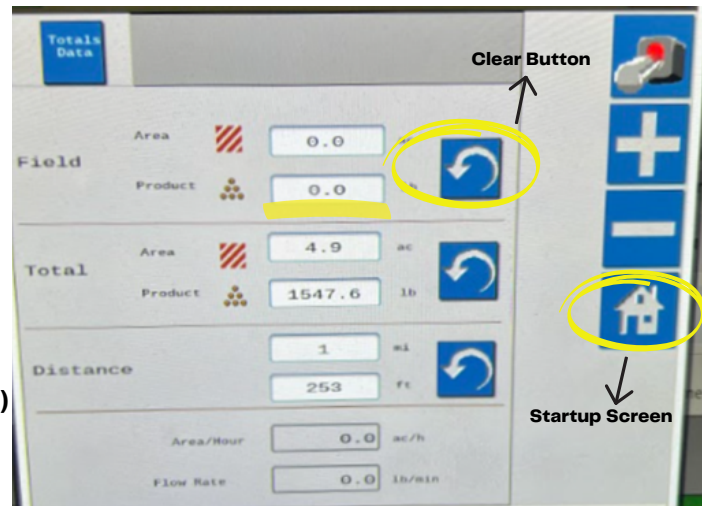

Starting Point For Calibration

SPREADER SETUP			
MACHINE:			N129459
FS800, RC800, OS170, F1210			
GATE OPENING INCHES	SPREADER CONSTANT	CUBIC FEET PER REVOLUTION	
1.00	3,170	0.0568	
2.00	1,664	0.1082	
3.00	1,132	0.1590	
4.00	880	0.2045	
5.00	702	0.2565	
6.00	601	0.2993	

Formula: Spreader Rate / Certified or Scale Weight = Value X Spreader Constant = New Spreader Constant

F1210 Fertilizer Spreader Diagnostics

Spreader Won't Turn On

1. Are your hydraulics on & activated in the right direction?

Yes

No

Make sure toggle (top right) & foot pedal/master switch is on.

Verify that your hoses are engaged & hooked up.

Yes

No

Check rate & density. Do you have a value?

Yes

No

If you are sitting still - enter self test speed.
If you are moving - make sure speed is showing.

Yes

No

Turn section control off in your screen .

Yes

No

Call service at 701-361-4790

Apron Won't Turn On

- Ensure coil is getting 12V power.
- Replace hydraulic coupler.

Apron Won't Shut Off

- Is there product in the spreader?

Yes

No

How much? (< 100lbs)

Put some product in.

Yes

No

If does not work, call us at 701-361-4790.

Add More Call Service

Spinner Not Reading

- Switch left/right motor sensor.
- Check Valve Cal - click 2nd tab from left, select spinner/fan control & set up valve cal.
- If problem persists, call service.

Check Valve Cal

Cal #	Model
20	660 Raven
200	IsoBus System Raven